



HT6380系列 变频输出专用滤波器

- 变频输出端专用
- 与输入HT5380系列配套使用，效果更佳



型 号	额定电流 A	连接方式			外壳
		 焊片	 螺栓	 铜排	
HT6380-6-M4-C31	6	--	M4	--	C31
HT6380-6-L8-C31	6	L8	--	--	C31
HT6380-8-M4-C31	8	--	M4	--	C31
HT6380-8-L8-C31	8	L8	--	--	C31
HT6380-10-M4-C31	10	--	M4	--	C31
HT6380-10-L8-C31	10	L8	--	--	C31
HT6380-13-M4-E32	13	--	M4	--	E32
HT6380-13-L8-E32	13	L8	--	--	E32
HT6380-16-M4-E32	16	--	M4	--	E32
HT6380-16-L8-E32	16	L8	--	--	E32
HT6380-20-M4-E32	20	--	M4	--	E32
HT6380-20-L8-E32	20	L8	--	--	E32
HT6380-25-M4-E32	25	--	M4	--	E32
HT6380-32-M6-G32	32	--	M6	--	G32
HT6380-42-M6-G32	42	--	M6	--	G32
HT6380-50-M6-G33	50	--	M6	--	G33
HT6380-65-M6-G33	65	--	M6	--	G33
HT6380-80-M8-G35	80	--	M8	--	G35
HT6380-100-M8-G35	100	--	M8	--	G35
HT6380-120-M8-G35	120	--	M8	--	G35
HT6380-150-M10-G36	150	--	M10	--	G36
HT6380-180-M10-G36	180	--	M10	--	G36
HT6380-250-Bar-Y5A	250	--	--	Bar	Y5A
HT6380-420-Bar-Y6A	420	--	--	Bar	Y6A
HT6380-630-Bar-Y7A	630	--	--	Bar	Y7A
HT6380-800-Bar-Y10A	800	--	--	Bar	Y10A
HT6380-1000-Bar-Y10A	1000	--	--	Bar	Y10A

* 连接方式：L8-焊片（6.3*0.8）；M4-M4螺栓；M6-M6螺栓；M8-M8螺栓；M10-M10螺栓；Bar-铜排。

工作频率：0~400Hz

额定电压:440VAC

额定电流：6~1000A（50℃时），最大值

温度范围:-25℃~+100℃

耐压测试(2秒钟): 2250VDC(L-L) 2700VDC(L-E)



HUGETON

惠博顿

HT6380系列 变频输出专用滤波器

外形尺寸

单位: mm 公差: ±1

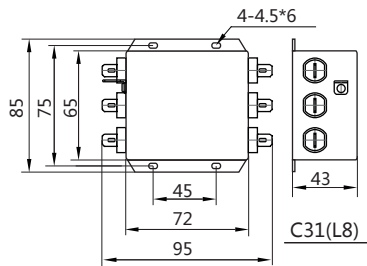

6~10A

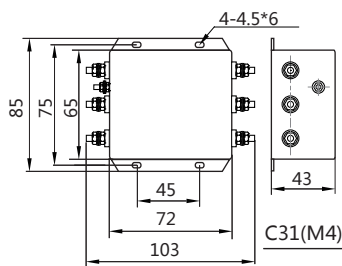

6~10A

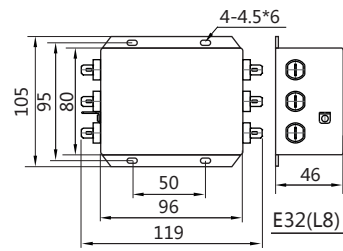

13~20A

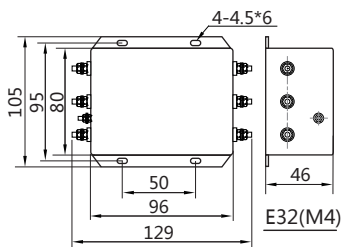

13~25A

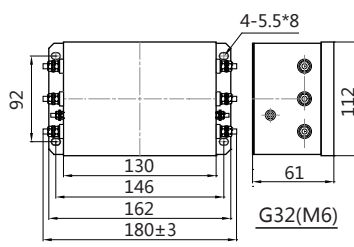

32~42A

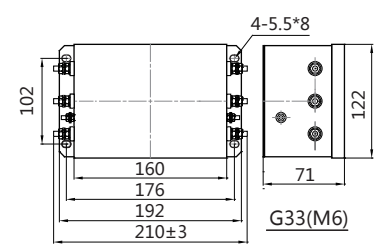

50~65A

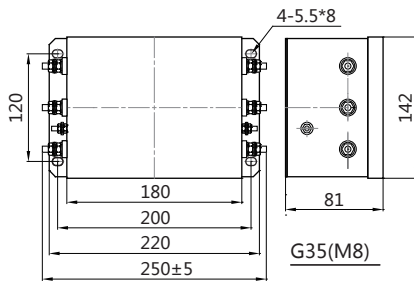

80~120A

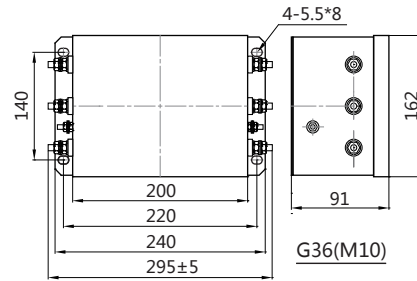

150A~180A

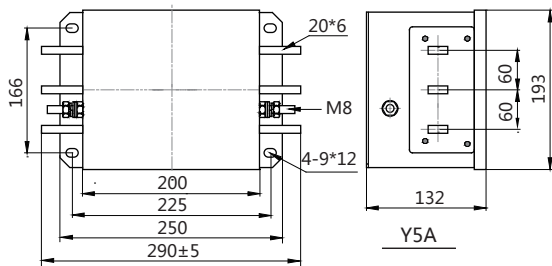

250A

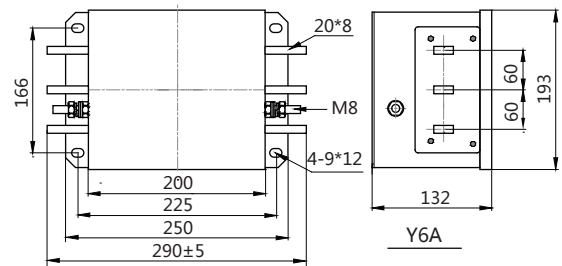

420A

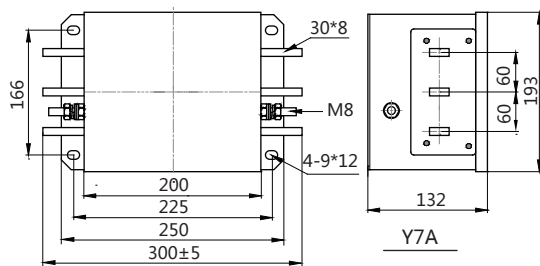

630A

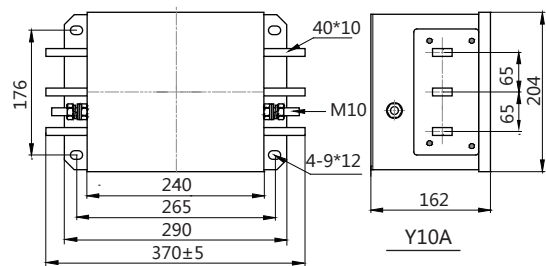

800~1000A